

## **Layered System for Intensive Rooftop Planters**

AMENITY DECKS AND ROOFTOP GARDENS

### **Description:**

Columbia Green's Layered System for Intensive Rooftop Planters is designed specifically for container planting on structure. This system combines the design of our Intensive Layered System with other common planter components like lightweight fill, insulation and a Vertical Drainage Layer get the most out of your container or planter wall design. This system balances weight, drainage and plant health for ornamental trees, shrubs and flowers in the unique conditions within the rooftop planter wall or container of your choosing.

The Layered System for Intensive Rooftop Planters is a deeper media system with Columbia Green Intensive growing media blend. The Intensive system provides maximum design flexibility. It consists of a root barrier, drainage layer, filtration layer, and optional lightweight foam fill (Geofoam, XPS or Foam Glass Aggregate). A Vertical Drainage Layer wraps the sides of the planter to eliminate hydrostatic pressure and promote drainage.

The system promotes plant health, allowing airflow in the drainage layer and through the media. This is a full Planter System that will bring the most thriving results on your rooftop garden.

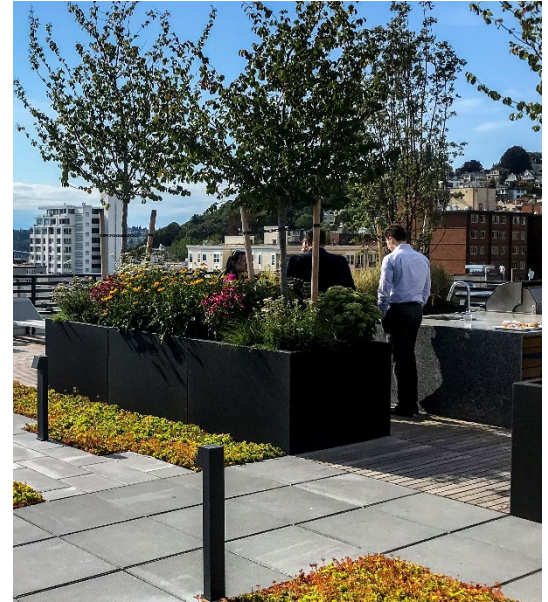

### **System Components:**

1. Columbia Green Root Barrier

*A physical barrier preventing root intrusion into underlying waterproofing membrane (For Open-Bottom Planters)*

- Description: 20 mils thick

2. 0.75" Drainage Layer

*Designed to mitigate excess moisture through ventilation and promote efficient drainage of the growing media*

- Description: .75" Thick highly permeable three-dimensional entangled polypropylene matrix
- Installation: Do not overlap material. Install parallel to slope.

3. Filtration layer

*Adhered to the Drainage Layer, prevents erosion of the growing media*

- Description: Durable spun-bonded polyester with non-directional weave
- Installation: Overlap using provided 3" seams

4. Growing Media: Columbia Green Intensive Growing Media, Regionally Sourced

*See Columbia Green Intensive Growing Media Technical Information Sheet*

5. Vertical Drainage: Columbia Green Vertical Drainage Layer

*Designed to eliminate Hydrostatic Pressure at Planter Walls, can be installed over planter insulation*

6. Lightweight Fill: Columbia Green Geofoam, XPS Styrofoam Fill or Foam Glass Aggregate

*We have a range of lightweight fill options for deeper planters, insulating planter walls, or under mounded media on rooftops*

7. Plants: Selected by Designer

### **Storage:**

- Store components in a dry area.
- Store away from sources of ignition and extremely high temperatures.

**Precautions:**

- Avoid prolonged exposure to sunlight, heat, sparks and open flames.
- Wash exposed skin prior to eating, drinking or smoking and at the end of each shift.

**LEED Materials Transparency Information:**

Post-Consumer Recycled Content and Manufacturing Locations:

- Drainage 40% ; Euclid, Ohio 44117
- Filtration 0% ; Euclid, Ohio 44117
- Water Retention Please Inquire; Michigan City, IN 4636



**Packaging/Component Size:**

<b>Vertical Drainage Layer</b>	
Thickness:	0.25"
Dimension:	4' x 100'
Coverage:	400 ft <sup>2</sup>
Weight:	3.6 oz./yd <sup>2</sup>
Packaging:	22" ± dia. roll

<b>Filtration Layer (Attached to Drainage Layer)</b>	
Weight:	3 oz./yd <sup>2</sup> (0.33 oz./ft <sup>2</sup> )
<b>0.75" Drainage Layer, ML2105</b>	
Thickness:	0.75"
Dimension:	48" W. x 50' L.
Coverage:	200 ft <sup>2</sup>
Weight:	16oz./yd <sup>2</sup> (1.78 oz./ft <sup>2</sup> )
Packaging:	24" ± dia. roll

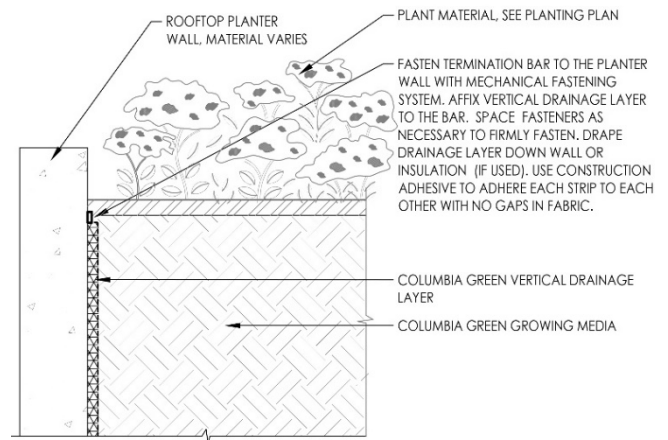

EX. Vertical Drainage Layer

**System Weight:** Saturated Weight of Growing Media will vary Regionally, typically 65-75 LBS/ CF in the West, 80-90 LBS/CF in the East and Midwest. Contact us for a Regionally-Specific system weight calculation.

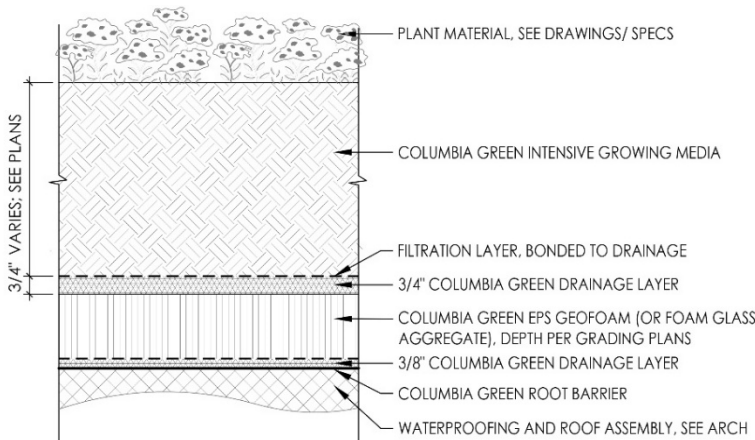

Ex. Rooftop Planter Layered System